

LEGEND

- ITEMS TO BE REMOVED & OR DEMOLISHED
- TREES / SHRUBS TO BE DEMOLISHED
- EXISTING TREES TO BE RETAINED, TREES WITHIN WORK SITE ZONES TO BE PROTECTED DURING DEMOLITION & CONSTRUCTION WORKS
- TAMWORTH MENTAL HEALTH UNIT BUILDING SITE
- CARPARK A ZONE 4 (SOUTH)
- CARPARK A ZONE 3 (ROAD)
- CARPARK B NORTH WEST ZONE 2
- CARPARK D NORTH EAST ZONE 1

NOTES

TAMWORTH MENTAL HEALTH UNIT BUILDING & CARPARK ZONES 1, 2, 3 & 4 AS LABELLED ON THIS DRAWING ARE ONLY PART OF THIS SCOPE

THIS DRAWING IS FOR SITE CONTEXT INFORMATION & IS NOT AN AUDIT OF EXISTING AS BUILT CONDITIONS OTHER THAN THOSE ALLOCATED IN THIS SCOPE OF WORKS

STAGING OF DEMOLITION WORKS TO BE CONFIRMED

ARCHITECTURAL DRAWINGS TO BE READ IN CONJUNCTION WITH CIVIL & SERVICES ENGINEER'S DOCUMENTATION

FOR EXISTING SERVICES ITEMS - REFER TO UTILITY MAPPING SURVEY INFORMATION & ALSO CIVIL & SERVICES ENGINEER'S DOCUMENTS

NOTE: SURVEY INFORMATION INDICATED HAS BEEN PROVIDED BY OTHERS. SURVEYS HAVE BEEN PRODUCED USING BOTH GDA84 & GDA2020. ALL SETOUTS TO BE VERIFIED ON SITE PRIOR TO ANY CONSTRUCTION

CAP-OFF & OR DIVERT, REMOVE ALL EXISTING SERVICES WHERE AFFECTED BY DEMOLITION WORKS - REFER TO SERVICES ENGINEER'S DOCUMENTATION

CONTRACTOR TO MANAGE DRAINAGE OVERFLOW PATH. REFER TO CIVIL DOCUMENTS FOR SEDIMENT AND EROSION CONTROL

ANY TREE REMOVAL OR WORKS NEAR TREES TO BE RETAINED REQUIRES TO BE SUPPORTED BY AN ABORIGINAL IMPACT ASSESSMENT. TREES TO BE RETAINED WITHIN THE CONSTRUCTION ZONE ARE TO BE PROTECTED DURING DEMOLITION/ CONSTRUCTION WORKS. REFER TO ARBORIST REPORT

REQUIREMENT FOR REPLACING TREES THAT ARE BEING REMOVED TO BE ADVISED BY THE REF REQUIREMENTS - ARBORIST

KEY PLAN

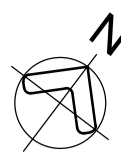

REV	DESCRIPTION	DRN	DATE
A	REF - DRAFT ISSUE 2	DP	11/11/2022
B	REF ISSUE	DP	02/12/2022
C	REF ISSUE	DP	10/02/2023
D	REF ISSUE	DP	15/02/2023
E	REF ISSUE	DP	06/07/2023
F	REF ISSUE	DP	20/07/2023

COPYRIGHT

ALL RIGHTS RESERVED. THIS WORK IS COPYRIGHT AND CANNOT BE REPRODUCED OR COPIED IN ANY FORM OR BY ANY MEANS (GRAPHIC, ELECTRONIC OR MECHANICAL INCLUDING PHOTOCOPYING) WITHOUT THE WRITTEN PERMISSION OF THE PRINCIPAL UNDER THE TERMS OF THE CONTRACT. ANY LICENCE, EXPRESS OR IMPLIED, TO USE THE DOCUMENT FOR ANY PURPOSE WHATSOEVER IS RESTRICTED TO THE TERMS OF THE AGREEMENT OR IMPLIED AGREEMENT WITH THE PRINCIPAL UNDER THE TERMS OF THE CONTRACT.

DIMENSIONS

USE FIGURED DIMENSIONS, DO NOT SCALE. CONTRACTORS MUST VERIFY ALL DIMENSIONS ON THE SITE BEFORE COMMENCING ANY WORK OR MAKING ANY SHOP DRAWING WHICH MUST BE SUBMITTED AND REVIEWED BEFORE MANUFACTURE.

FIXTURES, FITTINGS & EQUIPMENT SPECIFICATIONS

SUBSTITUTE FF&E EQUIPMENT SPECIFICATIONS

THE FIT-OUT DESIGN AND DOCUMENTATION HAS BEEN COMPLETED ON THE BASIS OF FF&E AND EQUIPMENT ADVISED TO THIS OFFICE AT THE TIME OF BRIEFING THE DESIGN. THE DESIGN PROVISIONS FOR FF&E AND EQUIPMENT INCORPORATES SPATIAL ALLOCATIONS, SERVICING, LOADING AND ACCESS CLEARANCES AND WHERE APPROPRIATE SERVICES REQUIREMENTS, HAVING DUE REGARD FOR SURROUNDING FIXTURES AND FITTINGS. IT SHOULD BE NOTED THAT SUBSTITUTE FF&E OR EQUIPMENT WITH ALTERNATE SPECIFICATIONS SHOULD NOT BE PROCURED PRIOR TO VALIDATING THOSE SPECIFICATIONS AGAINST THE ITEM CONTROL, SCHEDULE AND DESIGN PROVISIONS IN THE MODEL. THIS OFFICE ACCEPTS NO RESPONSIBILITY FOR THE PROCUREMENT OF SUBSTITUTE FF&E AND EQUIPMENT WHICH HAS NOT BEEN REVIEWED AND VALIDATED AGAINST THE ORIGINAL DESIGN PROVISIONS.

SERVICE POINTS DISCLAIMER

THE SERVICE POINTS IDENTIFIED ON THESE DRAWINGS HAVE BEEN OVERLAYED FROM THE BUILDING SERVICES ENGINEERING MODEL, AND ARE PROVIDED FOR INFORMATION AND SET-OUT PURPOSES ONLY. WE HAVE BEEN ADVISED BY THE SERVICES ENGINEERS THAT THE POINTS REPRESENTED ON THESE DRAWINGS ARE CORRECT AT THE TIME OF PUBLICATION. THIS OFFICE DOES NOT WARRANT THE ACCURACY OF THIS DATA. REFER TO THE BUILDING SERVICES ENGINEERING DOCUMENTATION FOR THE INSTALLATION OF THE SERVICES POINTS, AND THE INTERFACE BETWEEN THE SERVICES POINTS AND THE RESPECTIVE ENGINEERING SYSTEMS.

ISSUED FOR INFORMATION

ARCHITECTS



ABN: 21 134 476 065
PELACO COMPLEX, BUILDING 3, LEVEL 2
21-31 GOODWOOD ST, RICHMOND VIC 3121, AUSTRALIA
PH: (03) 9885 2333
THIS ARCHITECTURAL DESIGN IS THE COPYRIGHT OF
SILVER THOMAS HANLEY (AUS) PTY LTD ABN 21 134 476 065
AND SHALL NOT BE REPRODUCED WITHOUT THEIR WRITTEN PERMISSION

CLIENT

Hunter New England Local Health District



Health
Infrastructure

PROJECT

TAMWORTH MENTAL HEALTH UNIT

Dean Street Tamworth NSW

DRAWING TITLE





SITE PLAN - DEMOLITION OVERALL - REF

SCALE: As indicated@A1 DATE: 11/09/22 DRAWN BY: Author CHECKED: Checker

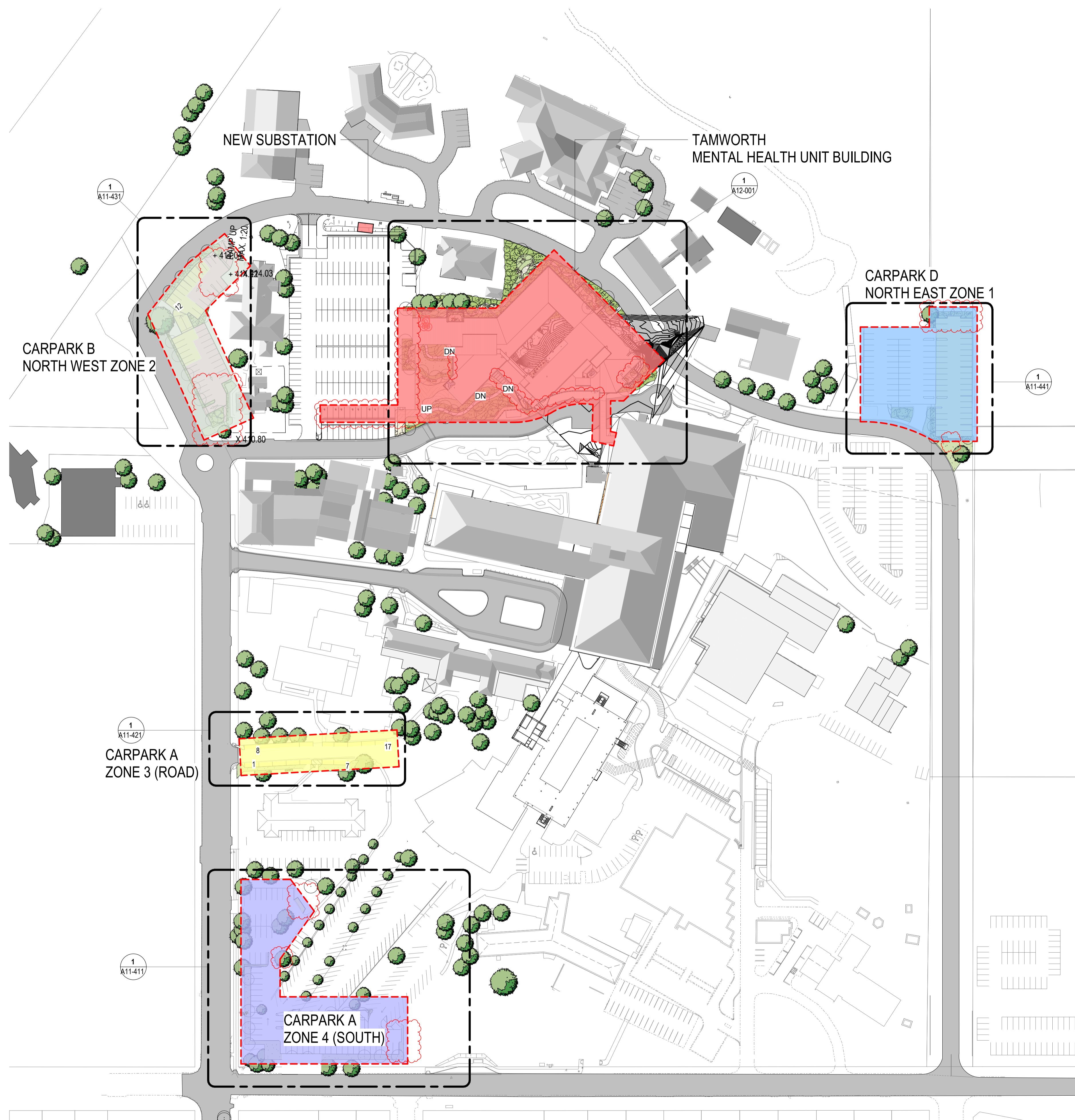
PROJECT No: 10500.1 DRAWING No: A10-000 REVISION: F

10500.1 A10-000

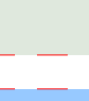
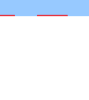

LEGEND	
	PROPOSED TAMWORTH MENTAL HEALTH UNIT BUILDING
	PROPOSED CARPARK A - ZONE 4 (SOUTH)
	PROPOSED CARPARK A - ZONE 3 (ROAD)
	PROPOSED CARPARK B - NORTH WEST ZONE
	PROPOSED CARPARK D - NORTH EAST ZONE
NOTES	
<p>THIS DRAWING IS FOR SITE CONTEXT INFORMATION & IS NOT AN AUDIT OF EXISTING AS BUILT CONDITIONS OTHER THAN THOSE ALLOCATED IN THIS SCOPE OF WORKS PER LEGEND SHOWN ABOVE</p> <p>ALL REDUCED LEVELS INDICATED ARE NOMINAL LEVELS & ARE TO BE CONFIRMED/ COORDINATED WITH CIVIL ENGINEERS DOCUMENTATION AND AGAINST SURVEY INFORMATION. GRADIENTS WITHIN CARPARK TO COMPLY WITH AS2890.1 & AS2890.6</p> <p>NOTE: SURVEY INFORMATION INDICATED HAS BEEN PROVIDED BY OTHERS. SURVEYS HAVE BEEN CONDUCTED USING BOTH GDA94 & GDA2020. ALL SETOUTS TO BE VERIFIED ON SITE PRIOR TO ANY CONSTRUCTION</p> <p>REFER TO CIVIL ENGINEER'S DOCUMENTS FOR FALLS TO EXISTING & NEW DRAINAGE PITS/OUTLETS & OSD/TREATMENT CHAMBERS</p> <p>ARCHITECTURAL DRAWINGS TO BE READ IN CONJUNCTION WITH CIVIL & SERVICES ENGINEERS DOCUMENTATION</p>	

[illegible]

COPYRIGHT

ALL RIGHTS RESERVED. THIS WORK IS COPYRIGHT AND CANNOT BE REPRODUCED OR COPIED IN ANY FORM OR BY ANY MEANS (GRAPHIC, ELECTRONIC OR MECHANICAL, INCLUDING PHOTOCOPYING) WITHOUT THE WRITTEN PERMISSION OF THE PRINCIPAL UNDER THE TERMS OF THE CONTRACT. ANY LICENCE, EXPRESS OR IMPLIED, TO USE THE DOCUMENT FOR ANY PURPOSE WHATSOEVER IS RESTRICTED TO THE TERMS OF THE AGREEMENT OR IMPLIED AGREEMENT WITH THE PRINCIPAL UNDER THE TERMS OF THE CONTRACT.

DIMENSIONS

USE FIGURED DIMENSIONS, DO NOT SCALE. CONTRACTORS MUST VERIFY ALL DIMENSIONS ON THE SITE BEFORE COMMENCING ANY WORK OR MAKING ANY SHOP DRAWING WHICH MUST BE SUBMITTED AND REVIEWED BEFORE MANUFACTURE.

FIXTURES, FITTINGS & EQUIPMENT SPECIFICATIONS

SERVICE POINTS DISCLAIMER

THE SERVICE POINTS IDENTIFIED ON THESE DRAWINGS HAVE BEEN OVERLAYED FROM THE BUILDING SERVICES ENGINEERING MODEL, AND ARE PROVIDED FOR INFORMATION AND SET-OUT PURPOSES ONLY. WE HAVE BEEN ADVISED BY THE SERVICES ENGINEER THAT THE POINTS REPRESENTED ON THESE DRAWINGS ARE CORRECT AT THE TIME OF PUBLICATION. THIS OFFICE DOES NOT WARRANT THE ACCURACY OF THIS DATA. REFERENCE TO THE BUILDING SERVICES ENGINEERING DOCUMENTATION FOR THE INSTALLATION OF THE SERVICE POINTS, AND THE INTERFACE BETWEEN THE SERVICE POINTS AND THE RESPECTIVE ENGINEERING SYSTEMS.

ISSUED FOR INFORMATION

— ARCHITECTS



ABN: 21 134 476 065
 PELACO COMPLEX, BUILDING 3, LEVEL 2
 21-31 GOODWOOD ST, RICHMOND VIC 3121, AUSTRALIA
 PH: (03) 9885 2333
 THIS ARCHITECTURAL DESIGN IS THE COPYRIGHT OF
 SILVER THOMAS HANLEY (AUS) PTY LTD ABN 21 134 476 065
 AND SHALL NOT BE REPRODUCED WITHOUT THEIR WRITTEN PERMISSION

____ CLIENT _____

Hunter New England Local Health District



**TAMWORTH MENTAL
HEALTH UNIT**

Dean Street Tamworth NSW

— DRAWING TITLE

**SITE PLAN - PROPOSED
OVERALL - REF**

SCALE DATE DRAWN BY CHECKED
As 11/09/22 Author Checker
indicated@A1

PROJECT No. 10500.1 DRAWING No. A01-002

G

LEGEND

- ITEMS TO BE REMOVED & OR DEMOLISHED
- TREES / SHRUBS TO BE DEMOLISHED
- EXISTING TREES TO BE RETAINED. TREES WITHIN WORK SITE ZONES TO BE PROTECTED DURING DEMOLITION & CONSTRUCTION WORKS

NOTES

THIS DRAWING IS FOR SITE CONTEXT INFORMATION & IS NOT AN AUDIT OF EXISTING AS BUILT CONDITIONS OTHER THAN THOSE ALLOCATED IN THIS SCOPE OF WORKS

ARCHITECTURAL DRAWINGS TO BE READ IN CONJUNCTION WITH CIVIL & SERVICES ENGINEER'S DOCUMENTATION

FOR EXISTING SERVICES ITEMS - REFER TO UTILITY MAPPING SURVEY INFORMATION & ALSO CIVIL & SERVICES ENGINEER'S DOCUMENTS

NOTE: SURVEY INFORMATION INDICATED HAS BEEN PROVIDED BY OTHERS. SURVEYS HAVE BEEN PRODUCED USING BOTH GDA94 & GDA2020. ALL SETOUTS TO BE VERIFIED ON SITE PRIOR TO ANY CONSTRUCTION

CAP-OFF & OR DIVERT, REMOVE ALL EXISTING SERVICES WHERE AFFECTED BY DEMOLITION WORKS - REFER TO SERVICES ENGINEER'S DOCUMENTATION

CONTRACTOR TO MANAGE DRAINAGE OVERFLOW PATH. REFER TO CIVIL DOCUMENTS FOR SEDIMENT AND EROSION CONTROL

ANY TREE REMOVAL OR WORKS NEAR TREES TO BE RETAINED REQUIRES TO BE SUPPORTED BY AN ABORIGINAL IMPACT ASSESSMENT. TREES TO BE RETAINED WITHIN THE CONSTRUCTION ZONE ARE TO BE PROTECTED DURING DEMOLITION/ CONSTRUCTION WORKS. REFER TO ARBORIST REPORT. TREE NUMBERS INDICATED ARE TO BE VERIFIED AGAINST THE ARBORIST REPORT PRIOR TO ANY REMOVAL/RETAINING.

REQUIREMENT FOR REPLACING TREES THAT ARE BEING REMOVED TO BE ADVISED BY THE REF REQUIREMENTS - ARBORIST

KEY PLAN

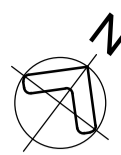

REV	DESCRIPTION	DRN	DATE
A	DRAFT ISSUE	DP	21/10/2022
B	FINAL DRAFT ISSUE	DP	10/11/2022
C	REF - DRAFT ISSUE 2	DP	11/11/2022
D	ISSUED FOR COORDINATION	DP	23/11/2022
E	REF ISSUE	DP	02/12/2022
F	ISSUE FOR TENDER	DP	14/12/2022
G	TENDER ADDENDUM ISSUE	DP	13/01/2023
H	REF ISSUE	DP	10/02/2023
J	REF ISSUE	DP	15/02/2023
K	REF ISSUE	DP	21/02/2023
L	ISSUED FOR CONSTRUCTION	DP	03/04/2023
M	ISSUED FOR COORDINATION	DP	27/04/2023
T	ISSUED FOR CONSTRUCTION	DP	08/05/2023
N	REF ISSUE	DP	06/07/2023
P	REF ISSUE	DP	20/07/2023

COPYRIGHT

ALL RIGHTS RESERVED. THIS WORK IS COPYRIGHT AND CANNOT BE REPRODUCED OR COPIED IN ANY FORM OR BY ANY MEANS (GRAPHIC, ELECTRONIC OR MECHANICAL INCLUDING PHOTOCOPYING) WITHOUT THE WRITTEN PERMISSION OF THE PRINCIPAL UNDER THE TERMS OF THE CONTRACT. ANY LICENCE, EXPRESS OR IMPLIED, TO USE THE DOCUMENT FOR ANY PURPOSE WHATSOEVER IS RESTRICTED TO THE TERMS OF THE AGREEMENT OR IMPLIED AGREEMENT WITH THE PRINCIPAL UNDER THE TERMS OF THE CONTRACT.

DIMENSIONS

USE FIGURED DIMENSIONS, DO NOT SCALE. CONTRACTORS MUST VERIFY ALL DIMENSIONS ON THE SITE BEFORE COMMENCING ANY WORK OR MAKING ANY SHOP DRAWING WHICH MUST BE SUBMITTED AND REVIEWED BEFORE MANUFACTURE.

FIXTURES, FITTINGS & EQUIPMENT SPECIFICATIONS

SUBSTITUTE FF&E EQUIPMENT SPECIFICATIONS

THE FIT-OUT DESIGN AND DOCUMENTATION HAS BEEN COMPLETED ON THE BASIS OF FF&E AND EQUIPMENT ADVISED TO THIS OFFICE AT THE TIME OF BRIEFING THE DESIGN. THE DESIGN PROVISIONS FOR FF&E AND EQUIPMENT INCORPORATES SPATIAL ALLOCATIONS, SERVICING, LOADING AND ACCESS CLEARANCES AND WHERE APPROPRIATE SERVICES REQUIREMENTS, HAVING DUE REGARD FOR SURROUNDING FIXTURES AND FITTINGS. IT SHOULD BE NOTED THAT SUBSTITUTE FF&E OR EQUIPMENT WITH ALTERNATE SPECIFICATIONS SHOULD NOT BE PROCURED PRIOR TO VALIDATING THOSE SPECIFICATIONS AGAINST THE ITEM CONTROL, SCHEDULE AND DESIGN PROVISIONS IN THE MODEL. THIS OFFICE ACCEPTS NO RESPONSIBILITY FOR THE PROCUREMENT OF SUBSTITUTE FF&E AND EQUIPMENT WHICH HAS NOT BEEN REVIEWED AND VALIDATED AGAINST THE ORIGINAL DESIGN PROVISIONS.

SERVICE POINTS DISCLAIMER

THE SERVICE POINTS IDENTIFIED ON THESE DRAWINGS HAVE BEEN OVERLAYED FROM THE BUILDING SERVICES ENGINEERING MODEL, AND ARE PROVIDED FOR INFORMATION AND SET-OUT PURPOSES ONLY. WE HAVE BEEN ADVISED BY THE SERVICES ENGINEERS THAT THE POINTS REPRESENTED ON THESE DRAWINGS ARE CORRECT AT THE TIME OF PUBLICATION. THIS OFFICE DOES NOT WARRANT THE ACCURACY OF THIS DATA. REFER TO THE BUILDING SERVICES ENGINEERING DOCUMENTATION FOR THE INSTALLATION OF THE SERVICES POINTS, AND THE INTERFACE BETWEEN THE SERVICES POINTS AND THE RESPECTIVE ENGINEERING SYSTEMS.

FOR CONSTRUCTION

ARCHITECTS



ABN: 21 134 476 065
PELAO COMPLEX, BUILDING 3, LEVEL 2
21-31 GOODWOOD ST, RICHMOND VIC 3121, AUSTRALIA
PH: (03) 9885 2333
THIS ARCHITECTURAL DESIGN IS THE COPYRIGHT OF
SILVER THOMAS HANLEY (AUS) PTY LTD ABN 21 134 476 065
AND SHALL NOT BE REPRODUCED WITHOUT THEIR WRITTEN PERMISSION
CLIENT

Hunter New England Local Health District



TAMWORTH MENTAL HEALTH UNIT

Dean Street Tamworth NSW

DRAWING TITLE

EARLY WORKS
CARPARK DEMOLITION PLAN
SOUTH WEST CARPARK A
ZONE 4

SCALE 1:200@A1 DATE 10/17/22 DRAWN BY DP CHECKED Checker

PROJECT No 10500.1 DRAWING No A11-202 REVISION

10500.1 A11-202

P

[illegible]

FOR CONSTRUCTION

ARCHITECTS



ABN: 1 21 134 476 065
PELACO COMPLEX BUILDING 3 LEVEL 2
21-31 GOODWOOD ST, RICHMOND VIC 3121, AUSTRALIA
PH: (03) 9885 2353
THIS ARCHITECTURAL DESIGN IS THE COPYRIGHT OF
SILVER THOMAS HANLEY (AUS) PTY LTD ABN 21 134 476 065
AND SHALL NOT BE REPRODUCED WITHOUT THEIR WRITTEN PERMISSION



NSW GOVERNMENT
PROJECT

Health Infrastructure

DRAWING TITLE			
EARLY WORKS CARPARK PLAN NORTH EAST CARPARK D ZONE 1			
SCALE	DATE	DRAWN BY	CHECKED
1:200@A1	10/12/22	DP	Checker
PROJECT No		DRAWING No	
10500.1		A11-441	
		REVISION	
		N	

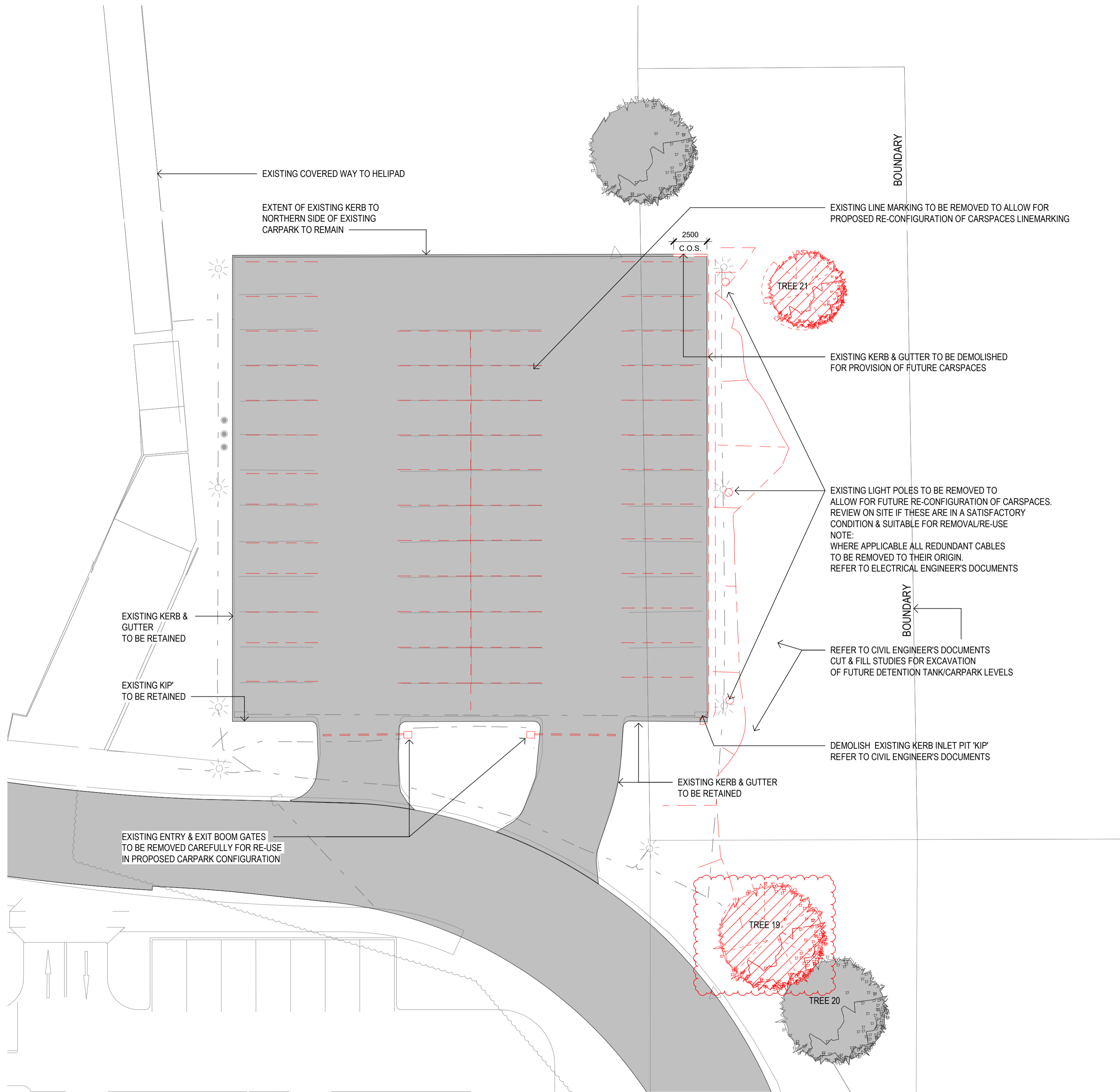

1 Site Plan - Demolition - Parking - CARPARK D - ZONE 1
SCALE: 1 : 200

LEGEND

ITEMS TO BE REMOVED & OR DEMOLISHED

TREES / SHRUBS TO BE DEMOLISHED

EXISTING TREES TO BE RETAINED.
TREES WITHIN WORK SITE ZONES TO BE PROTECTED DURING DEMOLITION & CONSTRUCTION WORKS

NOTES

THIS DRAWING IS FOR SITE CONTEXT/INFORMATION & IS NOT AN AUDIT OF EXISTING/AS BUILT CONDITIONS OTHER THAN THOSE ALLOCATED IN THIS SCOPE OF WORKS

ARCHITECTURAL DRAWINGS TO BE READ IN CONJUNCTION WITH CIVIL & SERVICES ENGINEERS DOCUMENTATION

FOR EXISTING SERVICES ITEMS - REFER TO UTILITY MAPPING SURVEY INFORMATION & ALSO CIVIL & SERVICES ENGINEERS DOCUMENTS

NOTE: SURVEY INFORMATION INDICATED HAS BEEN PROVIDED BY OTHERS. SURVEYS HAVE BEEN PRODUCED USING BOTH GDA94 & GDA2020. ALL SETOUTS TO BE VERIFIED ON SITE PRIOR TO ANY CONSTRUCTION

CAP-OFF & OR DIVERT, REMOVE ALL EXISTING SERVICES WHERE AFFECTED BY DEMOLITION WORKS - REFER TO SERVICES ENGINEERS DOCUMENTATION

CONTRACTOR TO MANAGE DRAINAGE OVERFLOW PATH. REFER TO CIVIL DOCUMENTS FOR SEDIMENT AND EROSION CONTROL

ANY TREE REMOVAL OR WORKS NEAR TREES TO BE RETAINED REQUIRES TO BE SUPPORTED BY AN ABORIGINAL IMPACT ASSESSMENT.
TREES TO BE RETAINED WITHIN THE CONSTRUCTION ZONE ARE TO BE PROTECTED DURING DEMOLITION/ CONSTRUCTION WORKS. REFER TO ARBORIST REPORT. TREE NUMBERS INDICATED ARE TO BE VERIFIED AGAINST THE ARBORIST REPORT PRIOR TO ANY REMOVAL/RETAINING.

REQUIREMENT FOR REPLACING TREES THAT ARE BEING REMOVED TO BE ADVISED BY THE REF REQUIREMENTS - ARBORIST

KEY PLAN

REV	DESCRIPTION	DRN	DATE
A	DRAFT ISSUE	DP	21/10/2022
B	FINAL DRAFT ISSUE	DP	10/11/2022
C	REF - DRAFT ISSUE 2	DP	11/11/2022
D	ISSUED FOR COORDINATION	DP	23/11/2022
E	REF ISSUE	DP	02/12/2022
F	ISSUE FOR TENDER	DP	14/12/2022
G	TENDER ADDENDUM ISSUE	DP	13/01/2023
H	REF ISSUE	DP	10/02/2023
J	REF ISSUE	DP	15/02/2023
K	REF ISSUE	DP	21/02/2023
L	ISSUED FOR COORDINATION	DP	19/04/2023
1	ISSUED FOR CONSTRUCTION	DP	08/05/2023
2	REF ISSUE	DP	20/07/2023

COPYRIGHT

ALL RIGHTS RESERVED. THIS WORK IS COPYRIGHT AND CANNOT BE REPRODUCED OR COPIED IN ANY FORM OR BY ANY MEANS (GRAPHIC, ELECTRONIC OR MECHANICAL INCLUDING PHOTOCOPYING) WITHOUT THE WRITTEN PERMISSION OF THE PRINCIPAL UNDER THE TERMS OF THE CONTRACT. ANY LICENCE, EXPRESS OR IMPLIED, TO USE THE DOCUMENT FOR ANY PURPOSE WHATSOEVER IS RESTRICTED TO THE TERMS OF THE AGREEMENT OR IMPLIED AGREEMENT WITH THE PRINCIPAL UNDER THE TERMS OF THE CONTRACT.

DIMENSIONS

USE FIGURED DIMENSIONS, DO NOT SCALE. CONTRACTORS MUST VERIFY ALL DIMENSIONS ON THE SITE BEFORE COMMENCING ANY WORK OR MAKING ANY SHOP DRAWING WHICH MUST BE SUBMITTED AND REVIEWED BEFORE MANUFACTURE.

FIXTURES, FITTINGS & EQUIPMENT SPECIFICATIONS

SUBSTITUTE FF&E EQUIPMENT SPECIFICATIONS
THE FIT-OUT DESIGN AND DOCUMENTATION HAS BEEN COMPLETED ON THE BASIS OF FF&E AND EQUIPMENT ADVISED TO THIS OFFICE AT THE TIME OF BRIEFING THE DESIGN. THE DESIGN PROVISIONS FOR FF&E AND EQUIPMENT INCORPORATES SPATIAL ALLOCATIONS, SERVICING, LOADING AND ACCESS CLEARANCES AND WHERE APPROPRIATE SERVICES REQUIREMENTS, HAVING DUE REGARD FOR SURROUNDING FIXTURES AND FITTINGS. IT SHOULD BE NOTED THAT SUBSTITUTE FF&E OR EQUIPMENT WITH ALTERNATE SPECIFICATIONS SHOULD NOT BE PROCURED PRIOR TO VALIDATING THOSE SPECIFICATIONS AGAINST THE ITEM CONTROL, SCHEDULE AND DESIGN PROVISIONS IN THE MODEL. THIS OFFICE ACCEPTS NO RESPONSIBILITY FOR THE PROCUREMENT OF SUBSTITUTE FF&E AND EQUIPMENT WHICH HAS NOT BEEN REVIEWED AND VALIDATED AGAINST THE ORIGINAL DESIGN PROVISIONS.

SERVICE POINTS DISCLAIMER

THE SERVICE POINTS IDENTIFIED ON THESE DRAWINGS HAVE BEEN OVERLAYED FROM THE BUILDING SERVICES ENGINEERING MODEL, AND ARE PROVIDED FOR INFORMATION AND SET-OUT PURPOSES ONLY. WE HAVE BEEN ADVISED BY THE SERVICES ENGINEERS THAT THE POINTS REPRESENTED ON THESE DRAWINGS ARE CORRECT AT THE TIME OF PUBLICATION. THIS OFFICE DOES NOT WARRANT THE ACCURACY OF THIS DATA. REFER TO THE BUILDING SERVICES ENGINEERING DOCUMENTATION FOR THE INSTALLATION OF THE SERVICES POINTS, AND THE INTERFACE BETWEEN THE SERVICES POINTS AND THE RESPECTIVE ENGINEERING SYSTEMS.

FOR CONSTRUCTION

ARCHITECTS

ABN: 21 134 476 065
PELAOO COMPLEX, BUILDING 3, LEVEL 2
21-31 GOODWOOD ST, RICHMOND VIC 3121, AUSTRALIA
PH: (03) 9885 2333
THIS ARCHITECTURAL DESIGN IS THE COPYRIGHT OF
SILVER THOMAS HANLEY (AUS) PTY LTD ABN 21 134 476 065
AND SHALL NOT BE REPRODUCED WITHOUT THEIR WRITTEN PERMISSION
CLIENT

Hunter New England Local Health District

TAMWORTH MENTAL HEALTH UNIT
Dean Street Tamworth NSW

DRAWING TITLE

**EARLY WORKS
CARPARK DEMOLITION PLAN
NORTH EAST CARPARK D
ZONE 1**

SCALE: 1:200@A1 DATE: 10/17/22 DRAWN BY: DP CHECKED: Checker

PROJECT No: 10500.1 DRAWING No: A11-205 REVISION: 2

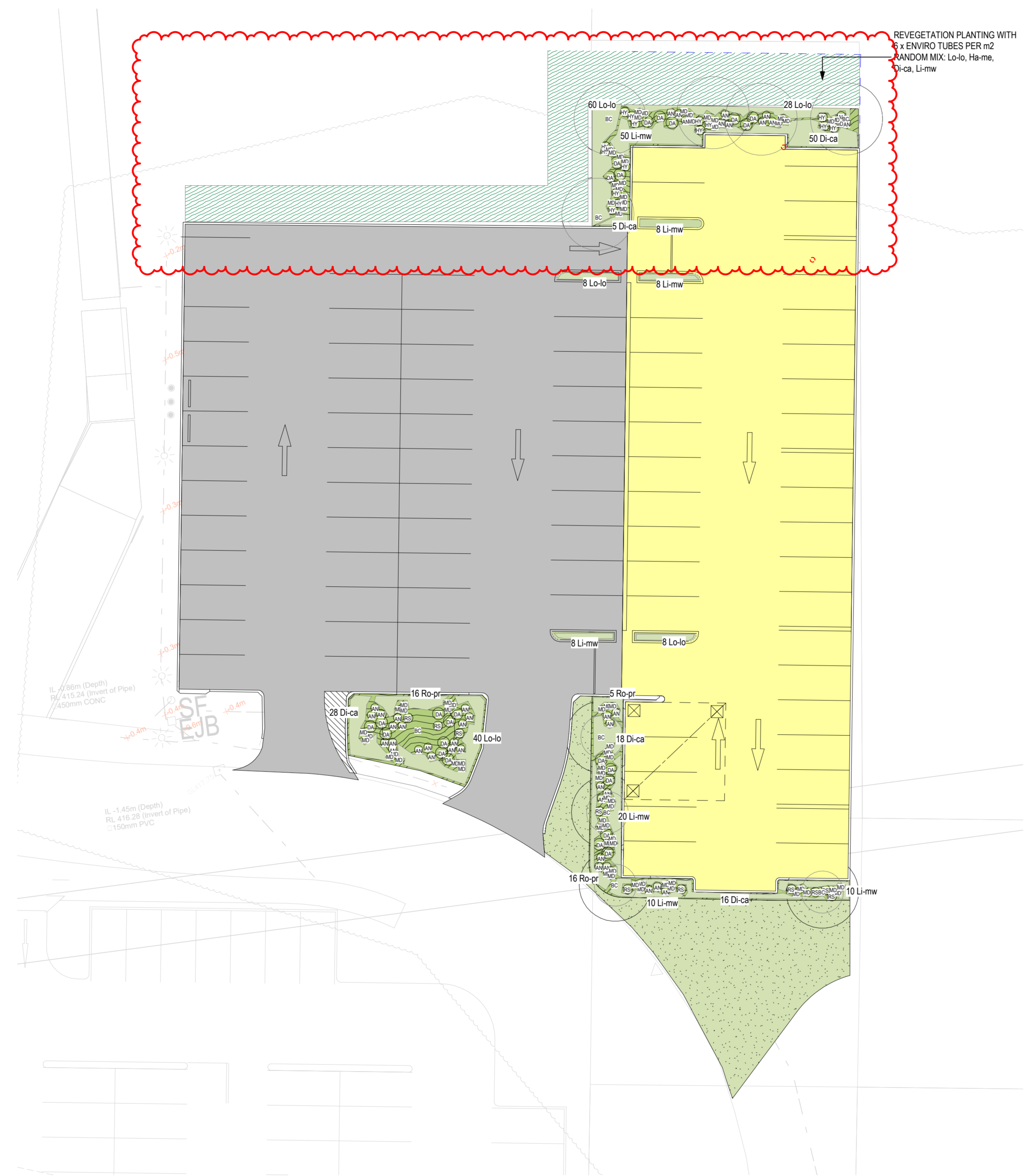

1 NORTH EAST CARPARK D ZONE 1 PLANTING PLAN
1 : 200

NOTES
1. Figure dimensions shall be taken in preference to scaling.
2. The contractor shall check all dimensions on-site before commencing work.

LEGEND

- NEW TREES
- NEW SHRUBS
- NEW GROUNDCOVERS

2	REVISED CARPARK	18.04.2023
1	EW TENDER ISSUE	13.01.2023

ISSUE	DESCRIPTION	DATE
-------	-------------	------

TaylorBrammer

TAYLOR BRAMMER LANDSCAPE ARCHITECTS PTY LTD
SYDNEY STUDIO

218 DUNDAS STREET
WOLLAHRA NSW 2025

T: +61 2 9397 8855
F: +61 2 9397 8755
E: SYDNEY@TAYLORBRAMMER.COM.AU

PROJECT:
TAMWORTH MENTAL HEALTH UNIT

DRAWING TITLE:
PLANTING PLAN NORTH EAST CARPARK D ZONE 1

CLIENT:
Silver Thomas Hanley, HNELHD, Health Infrastructure

SCALE	As Indicated	CHECKED	AL	DRAWING	REV
DATE	12/01/2023	DATE	21/02/2024	DATE	13/01/2023
DRAWN	MB	DESIGNED	AL		

Copyright of Taylor Brammer Landscape Architects Pty Ltd Ltd
ASB 01: 008 T24 000



1 CARPARK PLAN NORTH EAST CARPARK D ZONE 1
1 : 200

NOTES

1. Figure dimensions shall be taken in preference to scaling.
2. The contractor shall check all dimensions on site before commencing work.

LEGEND

- PL-00 PLANTING ON GRADE UNDER 1m HEIGHT
- TU-00 TURF ON GRADE
- NEW CARPARK TO ARCH. DETAIL
- EXISTING CARPARK TO BE RETAINED
- NEW TREE PLANTING
- EXISTING TREE RETAINED
- EXISTING TREE REMOVED

ISSUE	DESCRIPTION	DATE
5	REVISED CARPARK	09.05.2023
4	REV. TENDER ISSUE	13.01.2023
3	REF. SUBMISSION	12.01.2023
2	EARLY WORKS	06.12.2022
1	EARLY WORKS	25.11.2022

TaylorBrammer

TAYLOR BRAMMER LANDSCAPE ARCHITECTS PTY LTD
SYDNEY STUDIO

218 DUNDAS STREET
WOOLLAHRA NSW 2035

T: +61 2 8397 8855
F: +61 2 8397 8708
E: SYDNEY@TAYLORBRAMMER.COM.AU

PROJECT:
TAMWORTH MENTAL HEALTH UNIT

DRAWING TITLE:
CARPARK PLAN NORTH EAST CARPARK D ZONE 1

CLIENT:
Silver Thomas Hanley, HNELHD, Health Infrastructure

0 2 4 8 10m

SCALE: As Indicated
DATE: 12/01/2023
DRAWN: MB

CHECKED: AL
DATE: 21/02/23
DESIGNED: AL

DRAWING:
JOB: TBA-1000-PLAN
JOB NO: 126-00

REV:
1

Copyright of Taylor Brammer Landscape Architects Pty Ltd
ASB 01: 008 TBA 986

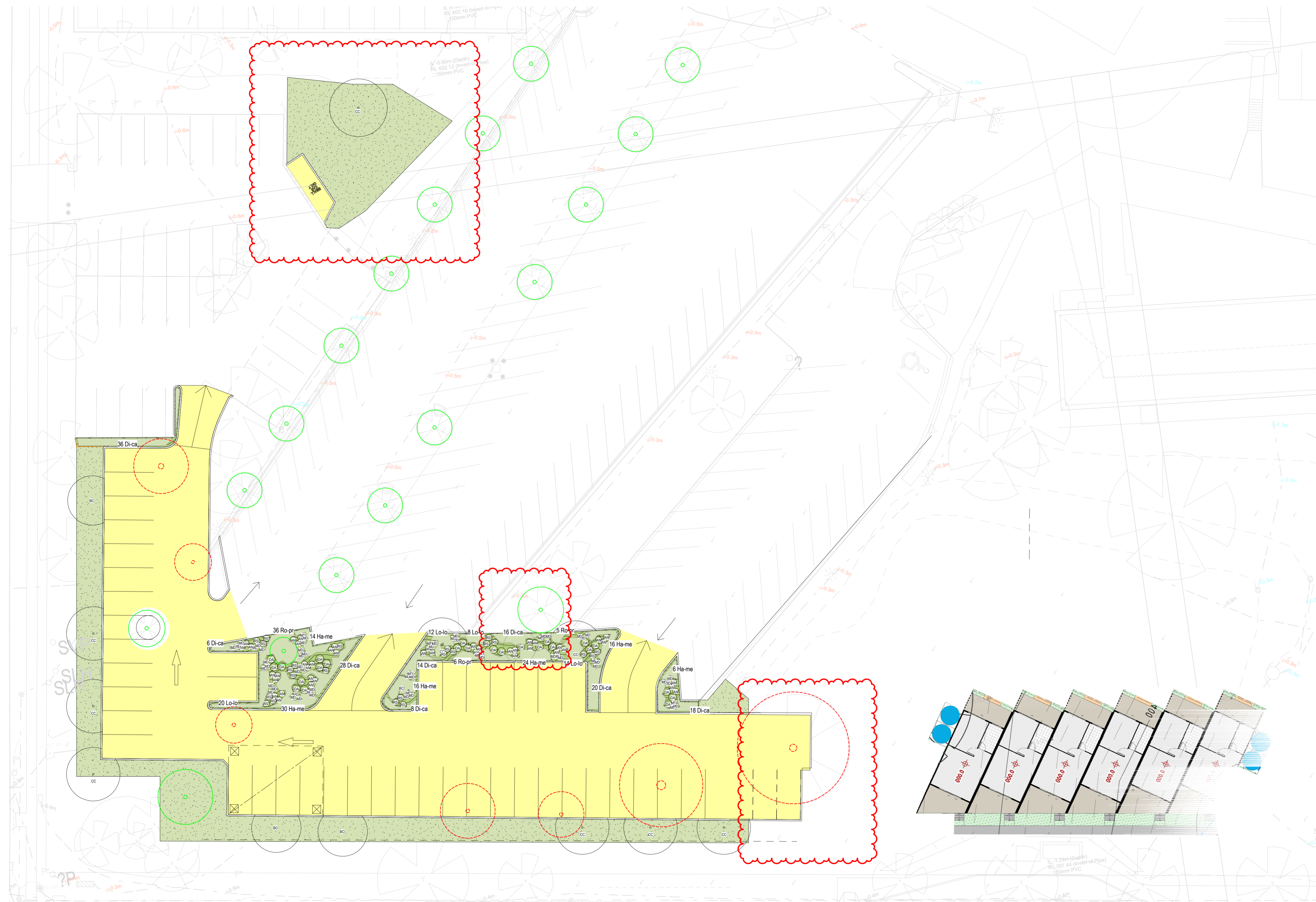

1 SOUTH WEST CARPARK A ZONE 4 PLANTING PLAN
1 : 200

NOTES
1. Figure dimensions shall be taken in preference to scaling.
2. The contractor shall check all dimensions on site before commencing work.

LEGEND

- NEW TREES
- NEW SHRUBS
- NEW GROUNDCOVERS

2	REVISED CARPARK	09.05.2023
1	NEW TENDER ISSUE	13.01.2023

ISSUE	DESCRIPTION	DATE
-------	-------------	------

TaylorBrammer
TAYLOR BRAMMER LANDSCAPE ARCHITECTS PTY LTD
SYDNEY STUDIO
114 O'ROURKE STREET
WOLLAKARA NSW 2255
T: +61 2 9397 8855
F: +61 2 9397 8855
E: SYDNEY@TAYLORBRAMMER.COM.AU

PROJECT:
TAMWORTH MENTAL HEALTH UNIT

DRAWING TITLE:
PLANTING PLAN SOUTH WEST CARPARK A ZONE 4

CLIENT:
Silver Thomas Hanley, HNELHD, Health Infrastructure

SCALE	As Indicated	CHECKED	AL	DRAWING	REV
DATE	13/01/2023	DATE	21/02/2024	ASD-TBL-ADP-PLAN	1
DRAWN	MB	DESIGNED	AL	137-025	2

Copyright of Taylor Brammer Landscape Architects Pty Ltd Ltd. ASB-01: 006 TBL-006

